

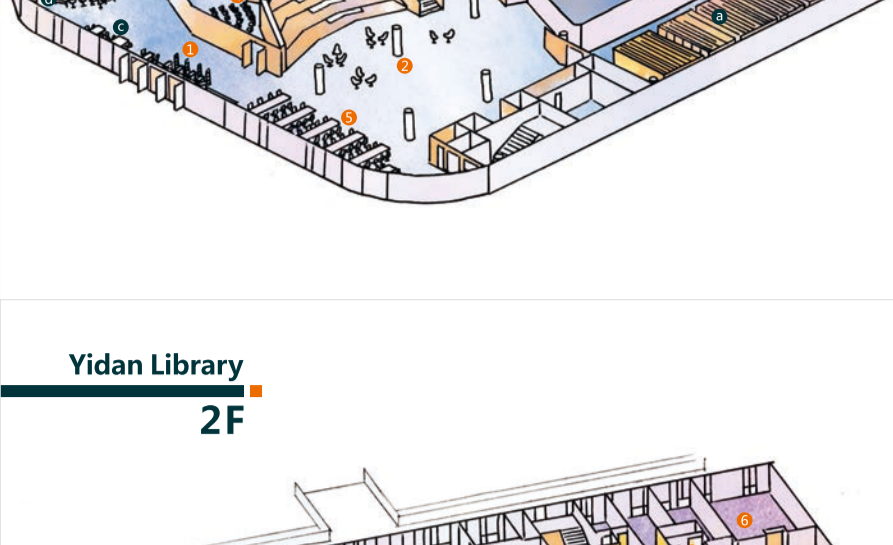

Yidan Library

1F



- 出入口 Entrance-Exit
- 中庭 Atrium
- 阶梯阅览区 Stairway Reading Space
- 放映厅 Studio
- 安静学习区 Quiet Study Space
- 饮水机 Water Dispenser
- 卫生间 Toilet
- 密集书库 Compact Shelves
- 复印区 Computer Hub
- 自助借还机 Self-Service Check-In/Out
- 自助文印 Printing
- 京东阅读机 JD Read

Yidan Library

2F



- 出入口 Entrance-Exit
- 服务台 Service Desk
- 安静学习区 Quiet Study Space
- 办公区 office
- 接待室 Guest Room
- 会议室 Meeting Room
- 展览区 Exhibition
- 饮水机 Water Dispenser
- 卫生间 Toilet
- 新书及报刊类 New Arrivals, Current Newspapers and Periodicals
- TP类图书 TP Books
- 教参类 Course Reserves
- 电脑区 Computer Hub
- 检索台 Retrieve Desk
- 自助借还机 Self-Service Check-In/Out
- 自助文印 Printing

Yidan Library

3F

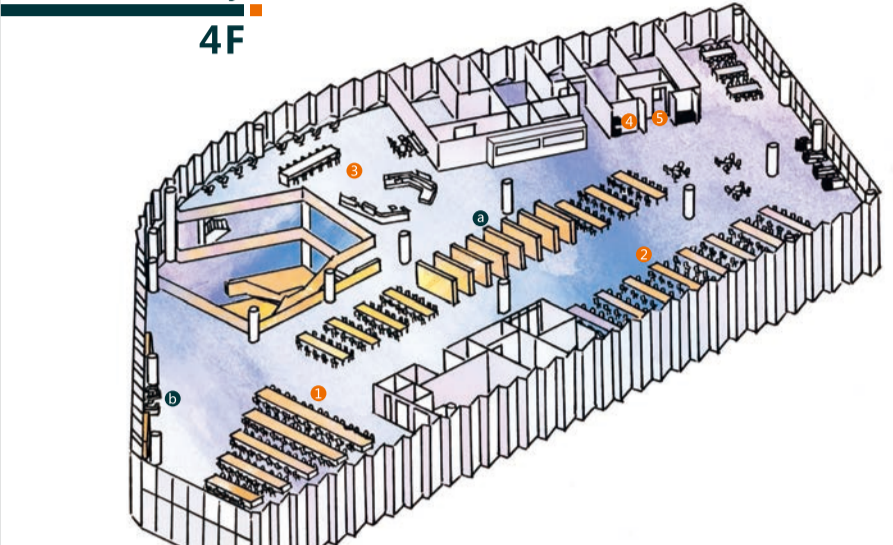

- 休闲阅览区 Leisure Reading Space
- 协作学习区 Collaborative Study Space
- 讨论间 Group Study Room
- 报告厅 Lecture Room
- 培训教室 Classroom
- 饮水机 Water Dispenser
- 卫生间 Toilet
- TA-TM类图书 TA-TM Books

Yidan Library

4F

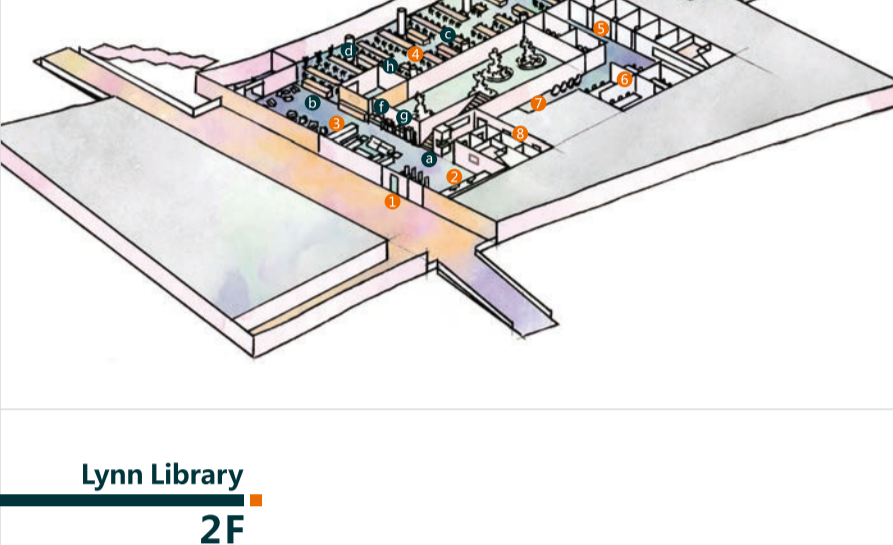

- 研习大厅 Grand Reading Room
- 安静学习区 Quiet Study Space
- 休闲阅览区 Leisure Reading Space
- 饮水机 Water Dispenser
- 卫生间 Toilet
- TN、TQ-TV类图书 TN、TQ-TV Books
- 汉译世界学术名著 Chinese Translation of Classics

Lynn Library

1F

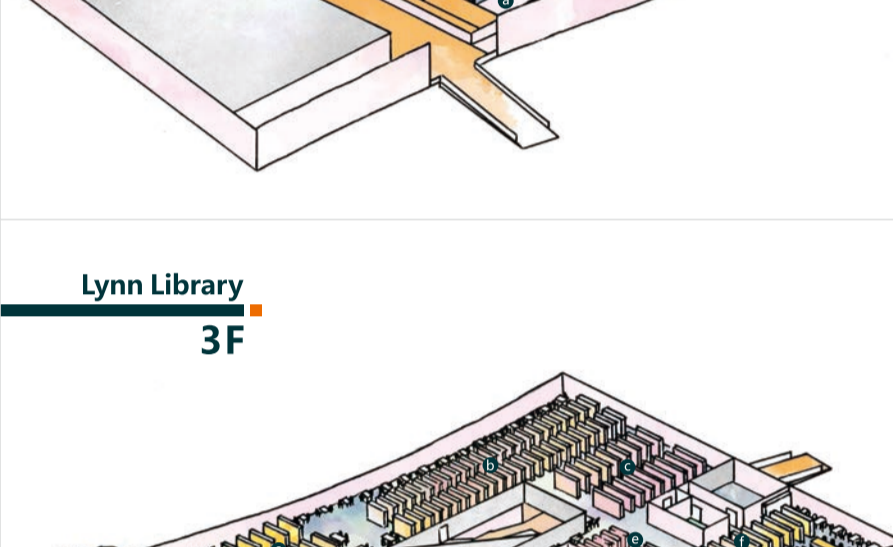

- 出入口 Entrance-Exit
- 服务台 Service Desk
- 报刊阅览区 Current Newspapers and Periodicals
- 安静学习区 Quiet Study Space
- 讨论间 Group Study Room
- 协作学习区 Collaborative Study Space
- 饮水机 Water Dispenser
- 卫生间 Toilet
- 思库推荐专架 Scholar Recommend
- 分级读物 Graded Readers
- 工具书 Reference Books
- 外文小说 Foreign Language Fictions
- 新书架 New Arrivals
- 检索台 Retrieve Desk
- 自助借还机 Self-Service Check-In/Out
- 自助文印 Printing

Lynn Library

2F

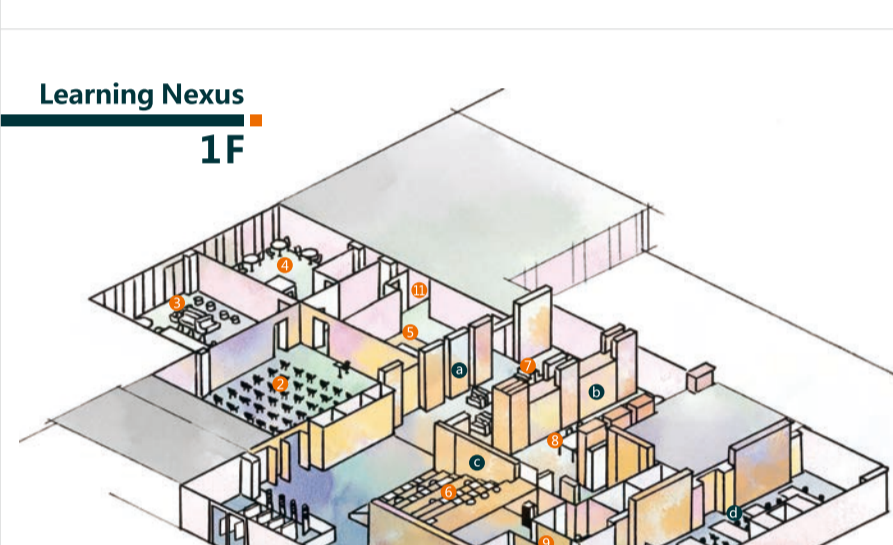

- 协作学习区 Collaborative Study Space
- 休闲阅览区 Leisure Reading Space
- 饮水机 Water Dispenser
- 卫生间 Toilet
- 视听资料 Audio-Visual Materials
- 电脑区 Computer Hub
- 24小时还书屋 Self-Service Book Returning Machine

Lynn Library

3F

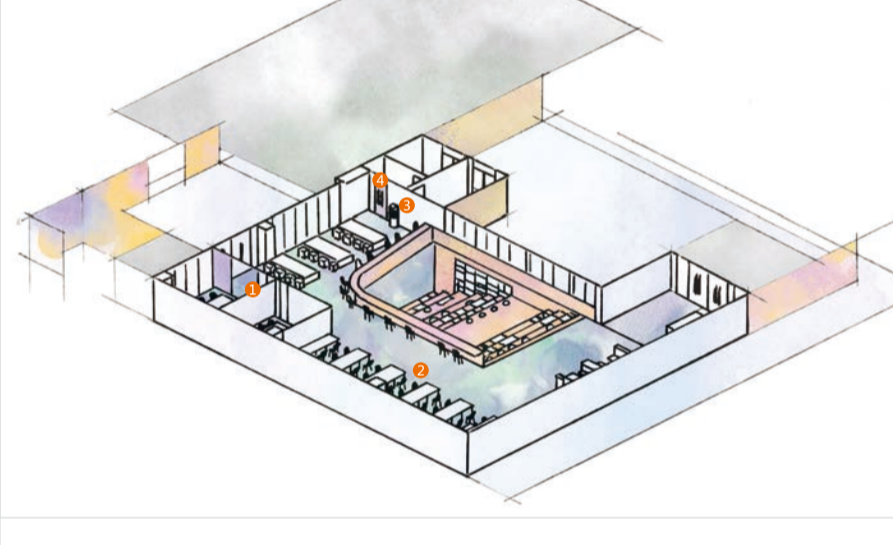

- 展览区 Exhibition
- 特藏室 Special Collection
- G309培训教室 Classroom 309
- 讨论间 Group Study Room
- 安静学习区 Quiet Study Space
- 饮水机 Water Dispenser
- 卫生间 Toilet
- F类图书 F Books
- F-J类图书 F-J Books
- J-K类图书 J-K Books
- N-O类图书 N-O Books
- O类图书 O Books
- P-S类图书 P-S Books, U-Z类图书 U-Z Books
- 电脑区 Computer Hub
- 自助借还机 Self-Service Check-In/Out
- 自助文印 Printing

Learning Nexus

1F

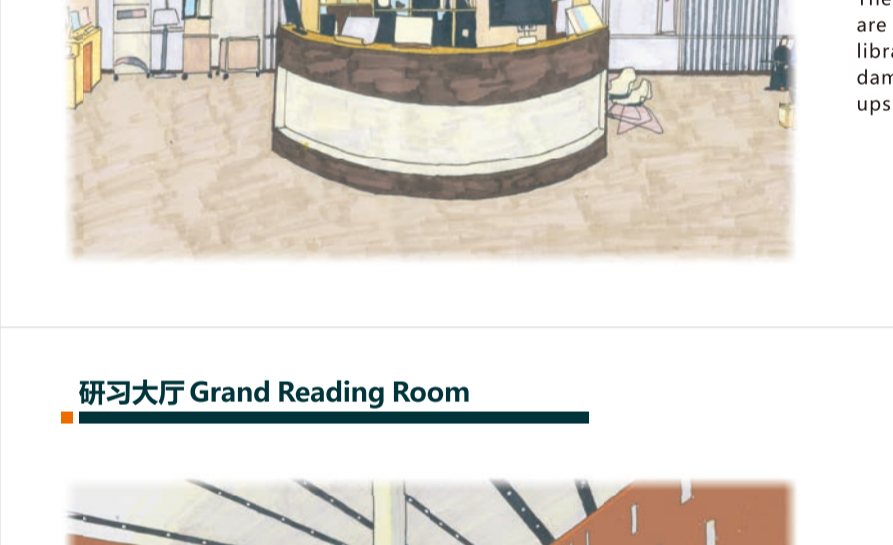

- 出入口 Entrance-Exit
- 报告厅 Lecture Room
- 教师活动室 Faculty Lounge
- 茶歇室 Tea Break Room
- 茶水间 Pantry
- 阶梯阅览区 Stairway Reading Space
- 休闲阅览区 Leisure Reading Space
- 协作学习区 Collaborative Study Space
- 讨论间 Group Study Room
- 展览区 Exhibition
- 卫生间 Toilet
- T类艺术典藏 Classical Art Books
- T类工具书 T Reference Books
- 电脑区 Computer Hub

Learning Nexus

2F

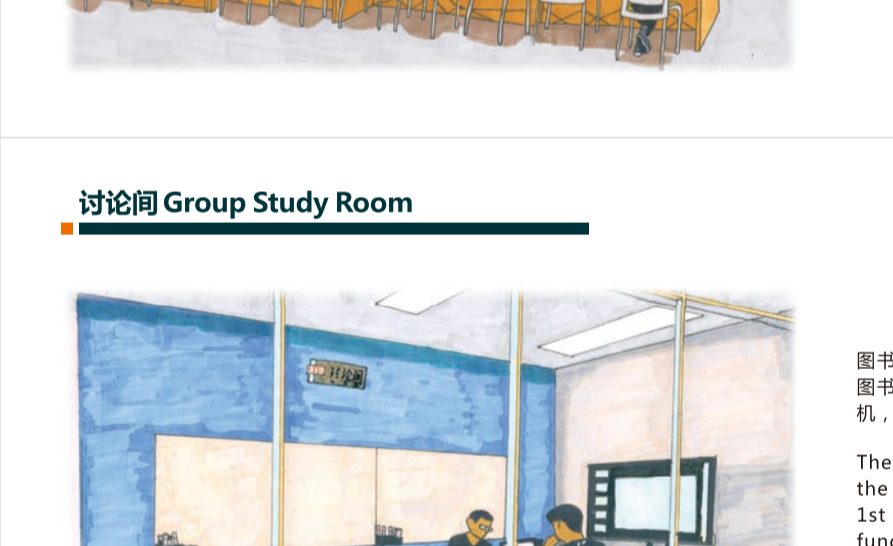

- 讨论间 Group Study Room
- 安静学习区 Quiet Study Space
- 饮水机 Water Dispenser
- 卫生间 Toilet

服务台 Service Desk

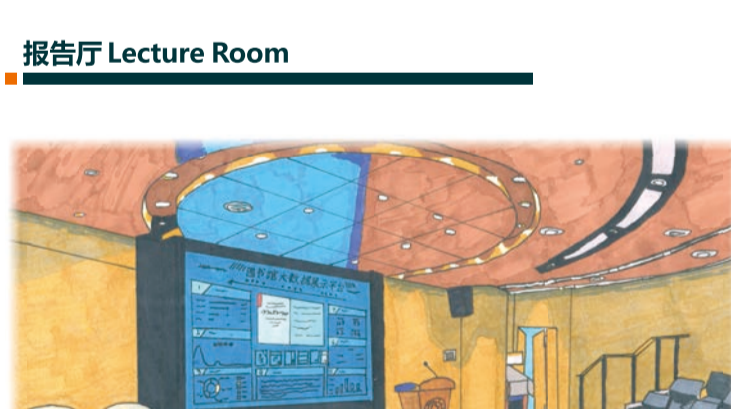

位于一丹图书馆二楼主出入口左边，服务时间：周一至周五8:30—22:00，可咨询、办理读者证借书、借书、缴纳图书逾期费、办理馆藏书刊污损/遗失赔偿、领取预约图书等业务，以及任何与图书馆相关问题的咨询服务，是图书馆对外服务的主要窗口。

The Service Desk is located on the 2nd floor of Yidan Library. Service hours are from 8:30 to 22:00, Monday to Sunday. Services offered include library card enquiry and authentication, overdue fee payment, damaged or lost item service, requested/recommended item pick-ups etc.

研习大厅 Grand Reading Room

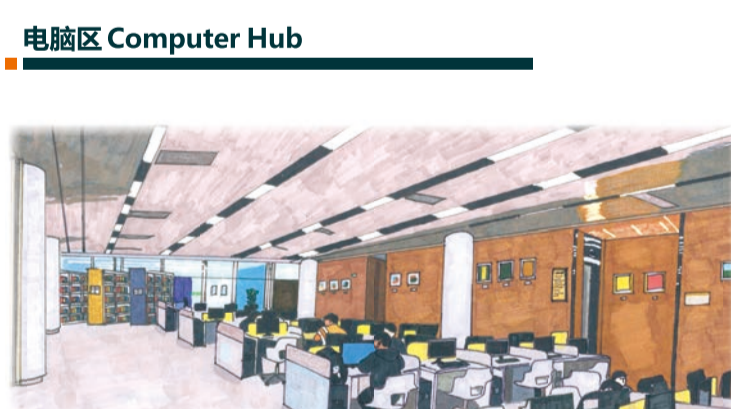

位于一丹图书馆四楼南面大玻璃窗区域，视野开阔，整个空间营造出一种沉浸式学习的氛围，共有阅览座位109个。

Located at the southern end of the fourth floor of Yidan Library with glass windows on three sides, the Grand Reading Room is the best place for SUSTechers to study individually as the high roof and the long tables with 109 seats create an excellent atmosphere for quiet studies.

讨论间 Group Study Room



图书馆讨论间分别位于一丹图书馆的三楼、琳恩图书馆的一楼和三楼、游泳池图书馆的一楼，共有22间。讨论间配有集电脑、电视、白板于一体的多功能一体机，可容纳3-10人不等，全校师生均可网上预约使用。

The SUStech Library has 22 Group Study Rooms which are located on the 3rd floor of Yidan Library, 1st & 3rd floors of Lynn Library, and 1st floor of Learning Nexus respectively. Equipped with a multi-function machine integrating computer, TV, and whiteboard, each room can accommodate 3-10 people. All faculty and students can use them by making reservations.

报告厅 Lecture Room



一丹图书馆三楼报告厅，其弧形阶梯式的设计风格独具特色，共有固定座位76个；另有游泳池图书馆一楼报告厅，有70个可移动座位。报告厅可用于举办各类小型学术研讨会，校内各部门和个人均可预约使用。

There are two lecture rooms in the SUStech Library. One on the 3rd floor of Yidan Library with 76 fixed seats, and one on the 1st floor of Learning Nexus. These rooms are good for small and medium-size meetings and activities, and all SUStech units and individuals can use them by booking in advance.

电脑区 Computer Hub



分别位于一丹图书馆一楼（36台电脑）和二楼（46台）、琳恩图书馆二楼（13台）和三楼（54台），以及游泳池图书馆一楼（10台）。

The Computer Hub can be found at all three libraries, with 82 computers on the 1st & 2nd floor at Yidan Library, 67 on the 2nd & 3rd floors of Lynn Library, and 10 on the 1st floor at Learning Nexus.

协作学习区 Collaborative Study Space



协作学习区位于一丹图书馆三楼和琳恩图书馆一楼，配有大面积的可供涂写的白板，满足读者讨论、演算等需要。

The Collaborative Study Spaces can be found on the 3rd floor of Yidan Library and 1st floor of Lynn Library. These spaces are equipped with large whiteboards to facilitate discussions and calculations.

思库推荐专架 Scholar Recommend



位于琳恩图书馆一楼入口处，专架所有图书均为本校师生所推荐阅读图书，每本书扉页贴有手写推荐语，均可借阅。

The Scholar Recommend shelf sits at the entrance of Lynn Library. Books recommended by SUSTechers are on display. On the title page of each book, a piece of paper is pasted with words hand-written by the SUSTecher for why he or she recommends the book.

阶梯阅览区 Stairway Reading Space

位于一丹图书馆一楼和游泳池图书馆一楼，读者可在该区域休闲阅读。

The Stairway Reading Spaces are located on the 1st floor of both Yidan Library and the Learning Nexus. Users of the library can spend time reading leisurely here.



Homepage



WeChat

CONTACT US

联系我们
Tel-Yidan Library : 0755-88010800
Tel-Lynn Library : 0755-88010755
Email : lib_ref@sustech.edu.cn

绘画 | 余彭歌 陈一诺 陈盛文

服务导向
Service

创新驱动
Innovation

读者至上
User-centeredness

协作共赢
Collaboration

愿景 Vision

作为学校初创、创新、创业事业中不可或缺的一员，图书馆将成为校园里一个便捷而又卓越的知识与学术活动中心。As an indispensable participant in the university's enterprise of excellence in research, innovation and entrepreneurship, the Library will be recognized as an accessible and exceptional center of knowledge and scholarly activities on campus.

使命 Mission

通过满足师生的信息和育人需要，图书馆为学校在教学、科研和创新方面的学术追求提供支持与服务。The Library supports the academic pursuits of teaching/learning, research and innovation by meeting the informational and educational needs of its campus community.